

Washer

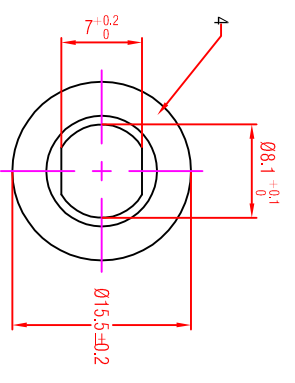

Washer

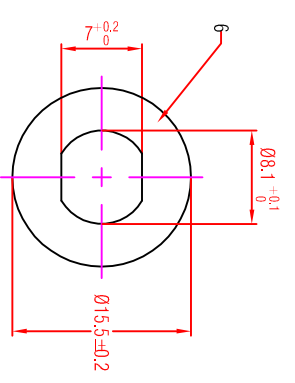

Nut (x2)

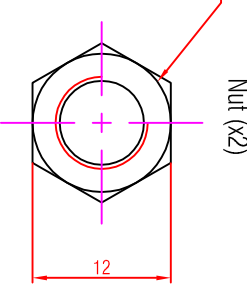

Isolated

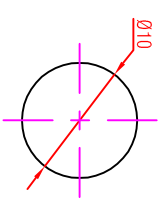

Note:
 1. All dimensions in mm.
 2. Tolerances not specified is ± 0.10 mm.
 3. Radius not specified is $R=0.20$ mm.

8	Bushing *	PAG + 10% GF
7	Ground Contact	Brass, Gold Plated
6	Washer *	PAG + 30% GF
5	Insulating Sleeve *	PAG + 30% GF
4	Washer *	PAG + 30% GF
3	Nut (x2)	Brass, Gold Plated
2	Housing	Brass, Gold Plated
1	Pin Contact	Brass, Gold Plated
No	Part Name	Material

Note: "*" indicates color of items 4,5,6 & 8

NYS367-*

- 0 - Black
- 2 - Red
- 4 - Yellow
- 5 - Green
- 6 - Blue
- 9 - White

Rev.	Revision Details	Date	Name	THIS DOCUMENT IS THE PROPERTY OF NENTEK. NO PART THEREOF MAY BE REPRODUCED AND USED WITHOUT THE FORTHWRITTEN CONSENT OF THE OWNER	Material: Scale: 2 : 1 (A3)	Designer: Checked: Approved: Replaced By:	Date: 2015.06.18 2015.06.18	Name: Xia HP Abraham